

DIMENSIONS ARE TO BE USED AS A QUICK REFERENCE ONLY, ACTUAL SIZES MAY VARY.

SEE SECOND SHEET FOR ADDITIONAL INFORMATION.

IF YOU USE THIS GUIDE TO CONSTRUCT YOUR WALL OPENINGS, BE SURE TO DOUBLE CHECK YOUR ACTUAL ROUGH OPENING DIMENSIONS BEFORE APPROVING / RELEASING YOUR AD SYSTEMS SHOP DRAWINGS FOR THE FABRICATION OF YOUR DOORS.

IT IS YOUR RESPONSIBILITY TO ENSURE THAT YOUR WALL OPENINGS ARE THE CORRECT SIZE TO FIT THE PROJECT SPECIFIC DOORS THAT YOU ORDER.

NOTES:

- * AD SYSTEMS STANDARD CLEAR OPENING IS 36" X 83 1/2" (3'-0" X 6'-11 1/2").
- ^ DOOR LEAVES OVER 48" WIDE ARE CONSIDERED "OVERSIZED". ADDITIONAL CHARGES AND LEAD TIMES WILL APPLY. SEE SECOND SHEET FOR ADDITIONAL INFORMATION.

DOOR PANEL WEIGHTS

FLUSH WOOD = 6.5 LBS PER SQ FT
 ALUMINUM FRAME WITH 1/4" GLASS = 4 LBS PER SQ FT

MAXIMUM SIZE FOR DOOR PANELS:

DOOR	WIDTH	HEIGHT
WOOD:	60"	120"
ALUMINUM FRAME WITH 1/4" GLASS:	120"	108"

WIDTH CALCULATIONS:

THE "CLEAR OPENING WIDTH" IS FROM THE INSIDE OF FRAME AT JAMB TO EDGE OF DOOR IN FULLY OPEN POSITION

- ROUGH OPENING = CLEAR OPENING PLUS (+) 6 1/2"
- DOOR LEAF = CLEAR OPENING PLUS (+) 7 1/4"
- VALANCE WIDTH = CLEAR OPENING TIMES (X) 2 PLUS (+) 10"

HEIGHT CALCULATIONS:

THE "CLEAR OPENING HEIGHT" IS FINISH FLOOR TO INSIDE OF FRAME AT HEAD

- ROUGH OPENING = CLEAR OPENING HEIGHT PLUS (+) 1"
- DOOR LEAF = CLEAR OPENING HEIGHT PLUS (+) 1/4"

SINGLE LEAF DOORS

BARN DOOR WIDTHS

CLEAR OPENING	ROUGH OPENING	DOOR LEAF	VALANCE WIDTH
32"	38 1/2"	39 1/4"	74"
32 1/2"	39"	39 3/4"	75"
33"	39 1/2"	40 1/4"	76"
33 1/2"	40"	40 3/4"	77"
34"	40 1/2"	41 1/4"	78"
34 1/2"	41"	41 3/4"	79"
35"	41 1/2"	42 1/4"	80"
35 1/2"	42"	42 3/4"	81"
* 36"	42 1/2"	43 1/4"	82"
36 1/2"	43"	43 3/4"	83"
37"	43 1/2"	44 1/4"	84"
37 1/2"	44"	44 3/4"	85"
38"	44 1/2"	45 1/4"	86"
38 1/2"	45"	45 3/4"	87"
39"	45 1/2"	46 1/4"	88"
39 1/2"	46"	46 3/4"	89"
40"	46 1/2"	47 1/4"	90"
40 1/2"	47"	47 3/4"	91"
40 3/4"	47 1/4"	48"	91 1/2"
41"	47 1/2"	^ 48 1/4"	92"
41 1/2"	48"	^ 48 3/4"	93"
42"	48 1/2"	^ 49 1/4"	94"
42 1/2"	49"	^ 49 3/4"	95"
43"	49 1/2"	^ 50 1/4"	96"
43 1/2"	50"	^ 50 3/4"	97"
44"	50 1/2"	^ 51 1/4"	98"
44 1/2"	51"	^ 51 3/4"	99"
45"	51 1/2"	^ 52 1/4"	100"
45 1/2"	52"	^ 52 3/4"	101"
46"	52 1/2"	^ 53 1/4"	102"
46 1/2"	53"	^ 53 3/4"	103"
47"	53 1/2"	^ 54 1/4"	104"
47 1/2"	54"	^ 54 3/4"	105"
48"	54 1/2"	^ 55 1/4"	106"
48 1/2"	55"	^ 55 3/4"	107"
49"	55 1/2"	^ 56 1/4"	108"
49 1/2"	56"	^ 56 3/4"	109"
50"	56 1/2"	^ 57 1/4"	110"
50 1/2"	57"	^ 57 3/4"	111"
51"	57 1/2"	^ 58 1/4"	112"
51 1/2"	58"	^ 58 3/4"	113"
52"	58 1/2"	^ 59 1/4"	114"
52 1/2"	59"	^ 59 3/4"	115"
52 3/4"	59 1/4"	^ 60"	115 1/2"

BARN DOOR HEIGHTS

CLEAR OPENING	ROUGH OPENING	DOOR LEAF
80"	81"	80 1/4"
80 1/2"	81 1/2"	80 3/4"
81"	82"	81 1/4"
81 1/2"	82 1/2"	81 3/4"
82"	83"	82 1/4"
82 1/2"	83 1/2"	82 3/4"
83"	84"	83 1/4"
* 83 1/2"	84 1/2"	83 3/4"
84"	85"	84 1/4"
84 1/2"	85 1/2"	84 3/4"
85"	86"	85 1/4"
85 1/2"	86 1/2"	85 3/4"
86"	87"	86 1/4"
86 1/2"	87 1/2"	86 3/4"
87"	88"	87 1/4"
87 1/2"	88 1/2"	87 3/4"
88"	89"	88 1/4"
88 1/2"	89 1/2"	88 3/4"
89"	90"	89 1/4"
89 1/2"	90 1/2"	89 3/4"
90"	91"	90 1/4"
90 1/2"	91 1/2"	90 3/4"
91"	92"	91 1/4"
91 1/2"	92 1/2"	91 3/4"
92"	93"	92 1/4"
92 1/2"	93 1/2"	92 3/4"
93"	94"	93 1/4"
93 1/2"	94 1/2"	93 3/4"
94"	95"	94 1/4"
94 1/2"	95 1/2"	94 3/4"
95"	96"	95 1/4"
95 1/2"	96 1/2"	95 3/4"
96"	97"	96 1/4"
96 1/2"	97 1/2"	96 3/4"
97"	98"	97 1/4"
97 1/2"	98 1/2"	97 3/4"
98"	99"	98 1/4"
98 1/2"	99 1/2"	98 3/4"
99"	100"	99 1/4"
99 1/2"	100 1/2"	99 3/4"
100"	101"	100 1/4"
100 1/2"	101 1/2"	100 3/4"
101"	102"	101 1/4"
101 1/2"	102 1/2"	101 3/4"
102"	103"	102 1/4"
102 1/2"	103 1/2"	102 3/4"
103"	104"	103 1/4"
103 1/2"	104 1/2"	103 3/4"
104"	105"	104 1/4"
104 1/2"	105 1/2"	104 3/4"
105"	106"	105 1/4"
105 1/2"	106 1/2"	105 3/4"
106"	107"	106 1/4"
106 1/2"	107 1/2"	106 3/4"
107"	108"	107 1/4"
107 1/2"	108 1/2"	107 3/4"
108"	109"	108 1/4"

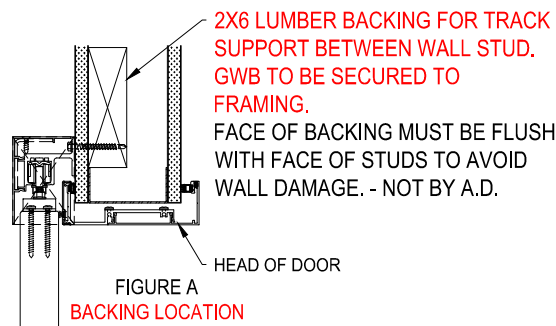
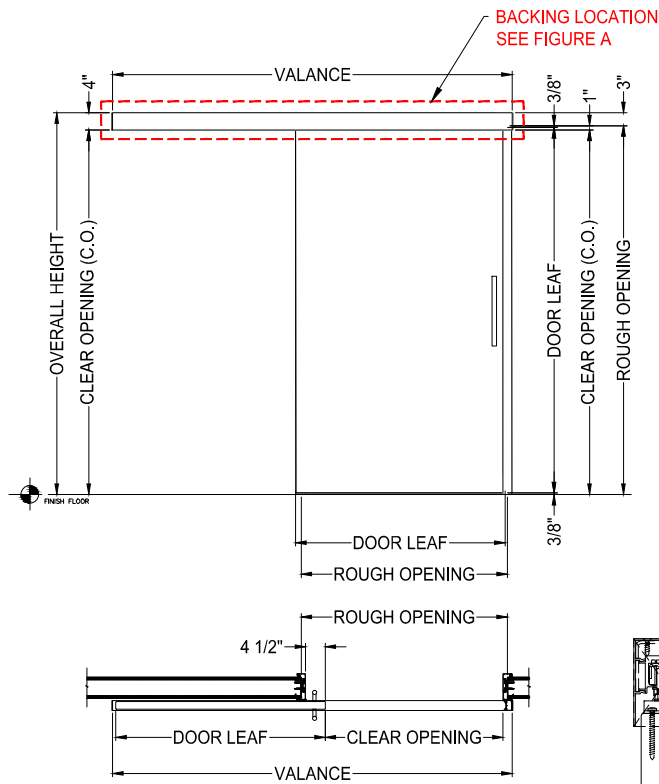

Innovation behind every door
 www.specADsystems.com
 1.425.374.1360

**AD SYSTEMS
 SINGLE BARN DOOR
 ROUGH OPENING GUIDE**

ALL EXISTING PRODUCT TESTING TO DATE HAS BEEN PERFORMED WITH 2X6 LUMBER BACKING IN THE WALL FOR ENTIRE LENGTH OF DOOR TRACK. THE BACKING IS REQUIRED TO PROVIDE ADEQUATE FASTENER PULL OUT RESISTANCE, AND ALSO INCREASED VERTICAL RESISTANCE TO "SEE-SAW" TILTING ACTION OF THE FASTENER OVER TIME DUE TO THE WEIGHT AND VIBRATION OF THE DOOR MOVEMENT.

USE OF ANY BACKING METHOD OR MATERIAL OTHER THAN 2X6 LUMBER BACKING, WOULD NEED TO BE VERIFIED BY THE CUSTOMERS AUTHORIZED PROJECT ENGINEER. AD SYSTEMS STANDARD WARRANTY WILL NOT COVER ANY ISSUES THAT RESULT FROM INADEQUATE WALL BACKING OR IMPROPER MOUNTING OF THE DOOR CARRIAGE TRACK.

